

**ASSEMBLY INSTRUCTIONS:**  
KH5, KH6, KH7

**ATTENTION**  
THIS INSTALLATION MAY  
REQUIRE 2 PEOPLE

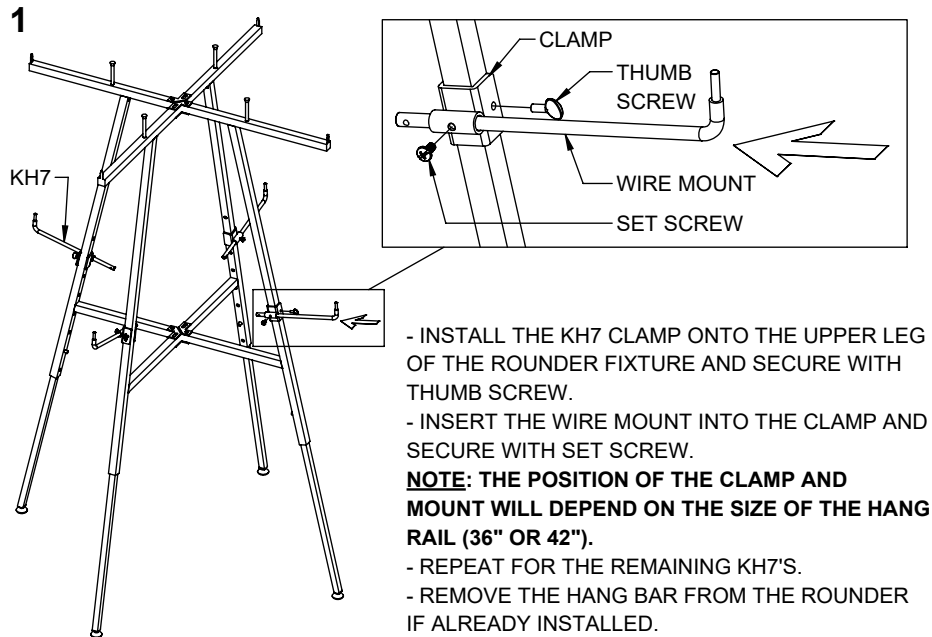

**KH5, KH6, KH7**

**2**

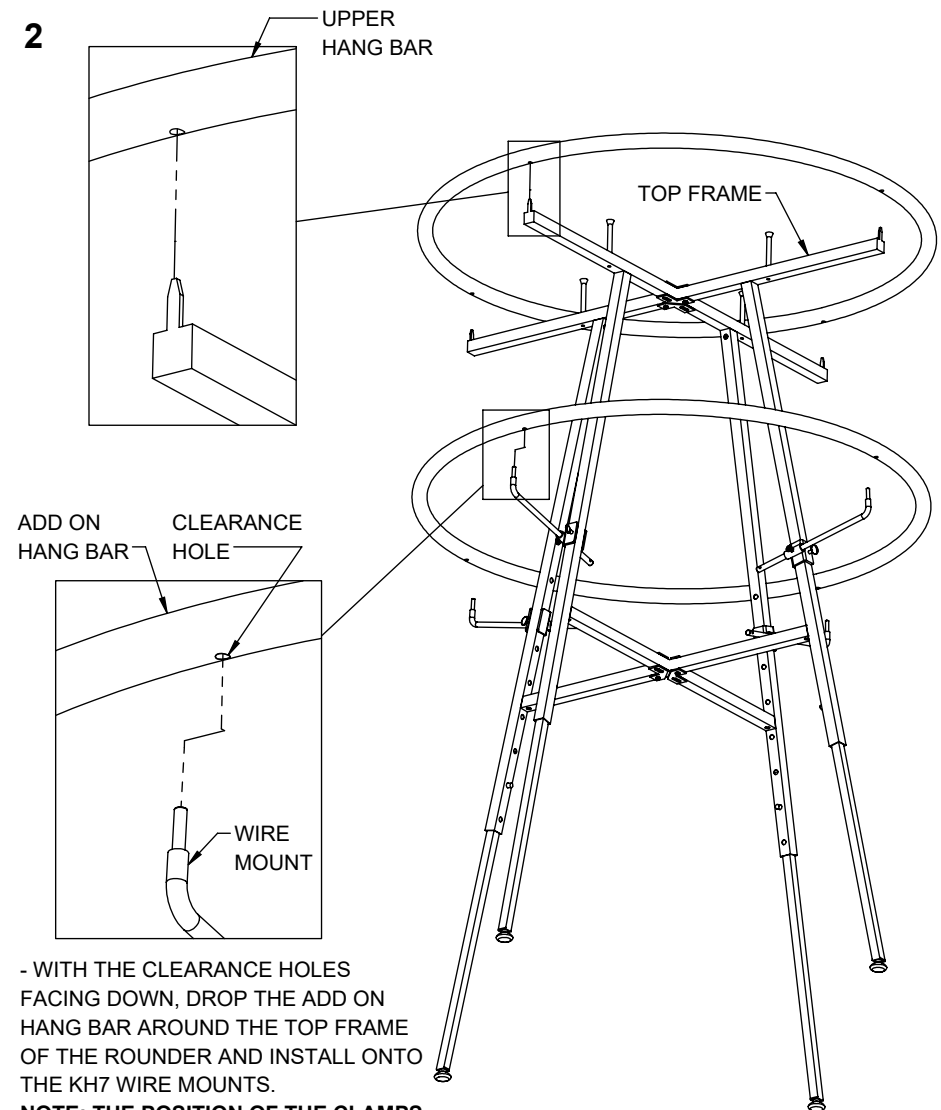

- WITH THE CLEARANCE HOLES FACING DOWN, DROP THE ADD ON HANG BAR AROUND THE TOP FRAME OF THE ROUNDER AND INSTALL ONTO THE KH7 WIRE MOUNTS.

**NOTE: THE POSITION OF THE CLAMPS AND WIRE MOUNT MAY HAVE TO BE ADJUSTED TO ALIGN WITH THE CLEARANCE HOLES IN THE ADD ON HANG BAR.**

- REINSTALL THE UPPER HANG BAR ONTO THE TOP FRAME OF THE ROUNDER FIXTURE.

**SHEET 1 OF 1**